

Items Needed to Obtain Permit:

1. Building Permit Application, and/or residential plumbing permit application, as applicable, to be filled out and the following supporting documents provided for Building Department Review:

Three (3) complete sets of the site plans ⁽¹⁾

Site plan must have the following:

- Show side, rear, and front setbacks from project to property line, septic, utilities, proposed or existing, to the site, etc.
- Utilities (proposed or existing) ⁽²⁾
- Boundaries
- Proposed or existing location of septic system
- Wells
- Accessory structure(s)
- Project location

Site plan must be signed and stamped by a NYS Design Professional

Two (3) complete sets of specifications ⁽¹⁾

NOTE:

- (1) Specifications and diagrams must adequately describe the nature of the work to be performed, material and equipment to be used/installed and details of structural, mechanical, electrical, plumbing and HVAC system.
- (2) This includes type and size of pipe and location of electrical service.

2. Current copy of Liability and Worker's Compensation Insurance Certificates **we doo not keep insurance on file , new permit =new insurance certificates**
3. All work must conform with the Building Code of New York State - **No Exceptions!**
4. Certified Schenectady County Health Department or Town Approval is required for new Septic systems.
5. Completion of Town of Rotterdam "Well Regulation Form" and Certification by approved Laboratory of water is required for private wells.
6. Obtain a permit from the County Highway Department (356-5340) or the Town Highway Department (355-7722) when any work, including construction or disturbance in the County or Town Highways Right-of-Way is necessary.
9. **Except as hereinafter provided, no person, firm, corporation, association, or partnership shall commence the construction, enlargement, alteration, improvement, removal or demolition of any building or structure or any portion thereof, or any land activity or development or install a solid fuel-burning heating apparatus, chimney, or flue in any dwelling unit without first having obtained a permit from the Building Inspector/Code Enforcement Officer of the Town of Rotterdam.**
10. **Any deviation from the approved plans must be authorized and approved by the Building Inspector.**

Building Set-Back and Minimum Lot Size Requirements

A-1 – Agricultural Zone

- A. Front yard depth shall be 25 feet.
- B. Side yard width shall be 15 feet.
- C. Rear yard depth shall be not less than 25 feet.
 - (1) For buildings exceeding three stories in height, 1/2 of the additional height shall be added to the minimum depth of 25 feet, except that a private garage may be built five feet from the rear and side property lines.
- D. Front property line: a minimum of 150 feet.
- E. The minimum lot area required for each principal use is one acre.

R-1 – One Family Residential District

- A. Front yard depth shall be 25 feet or a depth of not less than 1/2 the total setback depths of the dwellings on properties which adjoin on each side, provided that both of such dwellings are set back less than 25 feet.
- B. Side yard width shall be not less than 10 feet.
- C. Rear yard depth shall be not less than 25 feet, except that a garage may be built five feet from the rear and side property lines.
- D. The required minimum lot area shall be not less than 15,000 square feet, with a lot width of not less than 100 feet.
- E. The New York State Public Health Law governing realty subdivisions requires a minimum lot size of 20,000 square feet for every residential lot or parcel served by individual water and sewage disposal systems and located in a realty subdivision, as defined by Public Health Law, Article 11, Title II, entitled "Realty Subdivisions: Water Supply." Such stricter minimum lot size shall be imposed where applicable.

R-2 – Two Family Residential District

- A. Front yard depth shall be 30 feet.
- B. Side yard width shall be not less than 10 feet.
- C. Rear yard depth shall be not less than 25 feet. For buildings exceeding three stories in height, 1/2 of the additional height shall be added to the minimum depth of 25 feet, except that a private garage may be built five feet from the rear and side property line.
- D. The required minimum lot area shall be the same as for the R-1 District, except that residential buildings or structures with more than four bedrooms shall increase the total lot area by a minimum of 3,000 square feet for each additional bedroom over four, with a lot width of not less than 100 feet. Hospitals and similar uses shall require two acres.

R-3 – Multi-Family Residential District

- A. Front yard depth shall be 30 feet.
- B. Side yard width shall be not less than 20 feet.
- C. Rear yard depth shall be not less than 25 feet, except that a private garage may be built five feet from the rear and side property line.
- D. Increased yard depth. In reviewing every multiple-family project development plan, the Planning Board shall consider the yards and proposed screening of parking, common open space and buildings and may require provision of a yard depth up to twice the applicable yard requirements listed above, where such greater yard depth is necessary to preserve neighborhood character and property values.
- E. The minimum total lot area shall be 20,000 square feet, except that buildings or structures with more than four bedrooms shall increase the total lot area by a minimum of 3,000 square feet for each additional bedroom over four, with a minimum lot width of 100 feet

TOWN OF ROTTERDAM
Department of Public Works
1100 Sunrise Boulevard, Rotterdam, New York 12306
Phone: 518-355-7575, Ext. 395
Fax: 518-355-2725

**Notice of Utilization of Truss Type Construction
Pre-Engineered Wood Construction and/or Timber Construction**

To: The Town of Rotterdam Building Department (cc: Fire Department)

From: _____
[Name of Owner of Property]

Property Address: _____

Property Tax Map #: _____

Please take notice that the (check applicable line):

- _____ New residential structure
- _____ Addition to the existing residential structure
- _____ Rehabilitation of the existing residential structure

to be constructed or performed at the property referenced above will utilize (check each applicable line):

- _____ Truss type construction
- _____ Pre-engineered wood construction
- _____ Timber construction

in the following location(s) (check applicable line):

- _____ Floor framing (including girders and beams) **F**
- _____ Roof framing **R**
- _____ Floor framing and roof framing **FR**

Printed Name: _____

Signature: _____

Date: _____

Owner

Owner's Representative

Town of Rotterdam
Department of Public Works
1100 Sunrise Boulevard
Schenectady, NY 12306
Phone: 518-355-7575 x395
Fax: 518-355-2725

LETTER OF AUTHORIZATION FOR PERMIT AND ZONING APPLICATION

To Whom It May Concern:

I, _____, as owner of the property located
(print name)

at _____, Town of Rotterdam, in the

State of New York, hereby designate _____
(name)

(city, state, zip, and phone number)

**as my contractor and registered agent for the purposes of the applying for
Permits and Zoning representation regarding my building project.**

Printed Name: _____

Signature: _____

Date: _____

TOWN OF ROTTERDAM RESIDENTIAL PERMIT APPLICATION

Application is hereby made to the Building Department for the Issuance of a Building Permit pursuant to the New York State Building Construction Code for the construction of buildings, addition, alterations, or accessory structures, or for removal or demolition, as herein described. The applicant or owner agrees to comply with all applicable laws, ordinances, and regulations, and also will allow all Inspectors to enter the premises for the required inspections. All electrical work must be inspected and a Certificate of Approval granted from an approved Electrical Inspection Agency.

| | |
|------------------------------------|---------------------------------------|
| OFFICE USE ONLY | |
| Application _____ | |
| Approved: <input type="checkbox"/> | Disapproved: <input type="checkbox"/> |
| Cost of Permit: \$ _____ | |
| INITIALS _____ | |

| | |
|--|---|
| COST OF CONSTRUCTION: | \$\$\$ |
| Property Address: | |
| Property Owner: | |
| Property Owner Address: | |
| Property Owner Phone No.: | |
| Property Owner email: | |
| Applicant: | |
| Applicant Address: | |
| Applicant Phone No.: | |
| Applicant email: | |
| Contractor: | |
| Contractor Address: | |
| Contractor Phone No.: | |
| Email : | |
| Contractor Insurance: | Liability Workers Compensation (must be included with Application) |
| Classification of Work: <input type="checkbox"/> New Construction <input type="checkbox"/> Alteration <input type="checkbox"/> Repair <input type="checkbox"/> Demolition <input type="checkbox"/> Deck <input type="checkbox"/> Handicap Ramp <input type="checkbox"/> Attached Garage (Is there an existing garage: <input type="checkbox"/> Yes <input type="checkbox"/> No – If Yes, the size of the existing garage: _____) <input type="checkbox"/> Other (Describe) _____ Do you have: _____ Septic _____ Sewer | |
| Construction Class Type: 1A__1B__2A__2B__3A__3B__4A__4B__5A__5B__ | |
| Zoning: A-1 R-1 R-2 R-3 B-1 B-2 I-1 I-2 | |
| Setbacks: Front Yard: Existing _____ Proposed _____ Side Yard: Existing _____ Proposed _____ Rear Yard: Existing _____ Proposed _____ Septic System Separation distances from dwelling: Septic Tank 10' Field/pit 20' | |
| Description of Construction | |
| | |
| | |
| | |
| | |
| | |

Applicant's Signature: _____ Date: _____

TOWN OF ROTTERDAM RESIDENTIAL PLUMBING PERMIT APPLICATION

| OFFICE USE ONLY | |
|------------------------------------|---------------------------------------|
| Application # | _____ |
| Approved: <input type="checkbox"/> | Disapproved: <input type="checkbox"/> |
| Cost of Permit: \$ | _____ |
| INITIALS | _____ |

| OWNER INFORMATION | PLUMBER INFORMATION |
|-------------------|---|
| Name: | Name: |
| Address: | Address: |
| Phone: | Phone: |
| Email Address: | Email Address: |
| | Insurance Certificates: Liability Workers Compensation (must be included with application) |
| SITE INFORMATION | JOB DESCRIPTION |
| Location: | <input type="checkbox"/> New Plumbing |
| Street: | <input type="checkbox"/> Alteration of Existing Plumbing |
| Building Type: | <input type="checkbox"/> Residential |
| Building Use: | <input type="checkbox"/> Commercial |
| Est. Cost: | |

| FIXTURES | HOW MANY | FIXTURES | HOW MANY | FIXTURES | HOW MANY |
|-----------------------------|----------|----------------------|----------|-------------------------|----------|
| Back Flow Preventer | | Garbage Disposal | | Sediment Trap | |
| Bath or Shower | | Grease/Oil Separator | | Sewage Ejector | |
| Bidet | | Grease Trap | | Sinks | |
| Dental Cuspidor | | Hosebib/Sillcock | | Sump | |
| Dishwasher | | Hot Water Heater | | Washing Machine | |
| Drinking Fountain | | Indirect Waste | | Water Closets (toilets) | |
| Emergency Eyewash | | Laundry/Mop Sink | | Water Softener | |
| Emergency Shower | | Laundry Tray | | Underground Sprinkler | |
| Fire Prot. Sprinkler System | | Lavatories | | Urinal | |
| Floor Drains | | Roof Leader | | Other: | |
| TOTAL | | TOTAL | | TOTAL | |

THE FOLLOWING CONDITIONS ARE A PART OF THIS PERMIT:

APPLICANT CERTIFIES THAT ALL INFORMATION GIVEN IS CORRECT AND THAT ALL PERTINENT STATE AND LOCAL ORDINANCES WILL BE COMPLIED WITH IN PERFORMING THE WORK FOR WHICH THIS PERMIT IS ISSUED.

APPLICANT'S SIGNATURE

BUILDING INSPECTOR SIGNATURE

**TOWN OF ROTTERDAM
BUILDING DEPARTMENT
SEPTIC SYSTEM APPLICATION**

| OFFICE USE ONLY | |
|------------------------------------|---------------------------------------|
| Application#: | _____ |
| Approved: <input type="checkbox"/> | Disapproved: <input type="checkbox"/> |
| Cost of Permit: \$ | _____ |
| INITIALS | _____ |

| OWNER INFORMATION | CONTRACTOR INFORMATION |
|----------------------|------------------------|
| Name: _____ | Name: _____ |
| Address: _____ | Address: _____ |
| Phone No: _____ | Phone No: _____ |
| Email address: _____ | Email Address: _____ |

| SITE INFORMATION |
|---------------------------------|
| Address: _____ |
| Describe Existing System: _____ |
| Water Table Depth: _____ |

| JOB INFORMATION |
|--|
| <input type="checkbox"/> New Septic System <input type="checkbox"/> Tile/Leach Fields _____ length <input type="checkbox"/> Septic Tank _____ gal. <input type="checkbox"/> Distribution Box <input type="checkbox"/> Dozing Tank _____ gal. <input type="checkbox"/> Dry Well _____ gal. <input type="checkbox"/> Manhole/cleanout access |
| <input type="checkbox"/> Replacement of Septic Tank Explanation _____ |
| <input type="checkbox"/> Replacement of Leachfield Explanation _____ |
| <input type="checkbox"/> Replacement of Drywell Explanation _____ |
| <input type="checkbox"/> Replacement of Drywell with Leachfield Explanation _____ |
| <input type="checkbox"/> Replacement of Leachfield with Drywell <i>(Note: APPENDIX 75-A, Wastewater Treatment Standards – Individual Household Systems, Section 75-A.8(h)(2) Site Requirements. (i) If soil and site conditions are adequate for absorption trenches, seepage pits shall not be used.)</i> |
| Explanation _____ |
| PERC test results _____ |
| Water Table Elevation _____ |

THE FOLLOWING CONDITIONS ARE A PART OF THIS PERMIT:

APPLICANT CERTIFIES THAT ALL INFORMATION GIVEN IS CORRECT AND THAT ALL PERTINENT STATE AND LOCAL ORDINANCES WILL BE COMPLIED WITH IN PERFORMING THE WORK FOR WHICH THIS PERMIT IS ISSUED.

 APPLICANT'S SIGNATURE DATE

Septic Permit Information:

1. The Appendix 75-A of the Wastewater Treatment Standards for Individual Household Systems is used as the Town of Rotterdam’s guidelines.
2. All portions of newly installed septic system are not to be covered until approval by the Building Inspector.
3. Distribution box is to have water placed in it for inspection of proper leveling.
4. At time of Site Inspection, As-Built Drawing is to be provided to Building Inspector. Only official Town of Rotterdam form will be accepted.

SEPARATION DISTANCES FROM WASTEWATER SYSTEM COMPONENTS

| <u>System Components</u> | <u>Well or Suction Line</u> | <u>To Stream, Lake, watercourse (b), or Wetland</u> | <u>Dwelling</u> | <u>Property Line</u> |
|--|---|---|-----------------|----------------------|
| House sewer (watertight joints) | 25’ if cast iron pipe, 50’ otherwise | 25’ | 10’ | 10’ |
| Septic Tank | 50’ | 50’ | 10’ | 10’ |
| Effluent line to distribution box | 50’ | 50’ | 10’ | 10’ |
| Distribution Box | 100’ | 100’ | 20’ | 10’ |
| Absorption field | 100’ (a) | 100’ | 20’ | 10’ |
| Seepage Pit | 150’ (a) | 100’ | 20’ | 10’ |
| Dry well (roof and footing) | 50’ | 25’ | 20’ | 10’ |
| Raised or Mound system (c) | 100’ (a) | 100’ | 20’ | 10’ |
| Evapotranspiration – absorption system (c) | 100’ (a) | 50’ | 20’ | 10’ |
| Composter | 50’ | 50’ | 20’ | 10’ |

NOTES:

- (a) When sewage treatment systems are located in coarse gravel or upgrade and in the general path of drainage to a well, the closest part of the treatment system shall be at least 200 feet away from the well.
- (b) Mean high water mark.
- (c) For all systems involving the placement of fill material, separation distances are measured from the toe of slope of the fill.

MINIMUM SEPTIC TANK CAPACITIES

| <u>Number of Bedrooms</u> | <u>Minimum Tank Capacity (gallons)</u> | <u>Minimum Liquid Surface Area (sq.ft.)</u> |
|---------------------------|--|---|
| 1, 2, 3 | 1,000 | 27 |
| 4 | 1,250 | 34 |
| 5 | 1,500 | 40 |
| 6 | 1,750 | 47 |

NOTES:

- (1) Tank size requirements for more than six bedrooms shall be calculated by adding 250 gallons and seven square feet of surface area for each additional bedroom. A garbage grinder shall be considered equivalent to an additional bedroom for determining tank size.
- (2) Septic tank capacities shall be based upon the number of household bedrooms. An expansion attic shall be considered as an additional bedroom. The table above specifies minimum septic tank capacities and minimum liquid surface areas.
- (3) Septic tank covers shall always be accessible. Where manholes are more than 12 inches below final grade, an extension collar shall be provided over each opening. Extension collars shall not be brought flush with the ground surface unless the cover can be locked to prevent tampering. Driveways or other facilities shall not be constructed above septic tanks unless specially designed and reinforced to safely carry the load imposed.

FEES: Septic Permit \$150.00

TOWN OF ROTTERDAM
AS-BUILT SEWAGE DISPOSAL DIAGRAM

Owner: _____ Site Location: _____
Tax Map ID #: _____ Permit #: _____
Tank Size: New: _____ **OR** Existing tank size (if known): _____
Dry Wells: New: _____ Size: _____ **AND/OR** Existing: # _____ Size: _____
Drainfield: #Laterals: _____ Length of Laterals: _____ Width of Trench: _____

Final As-Built Diagram (refer to permit for requirements)

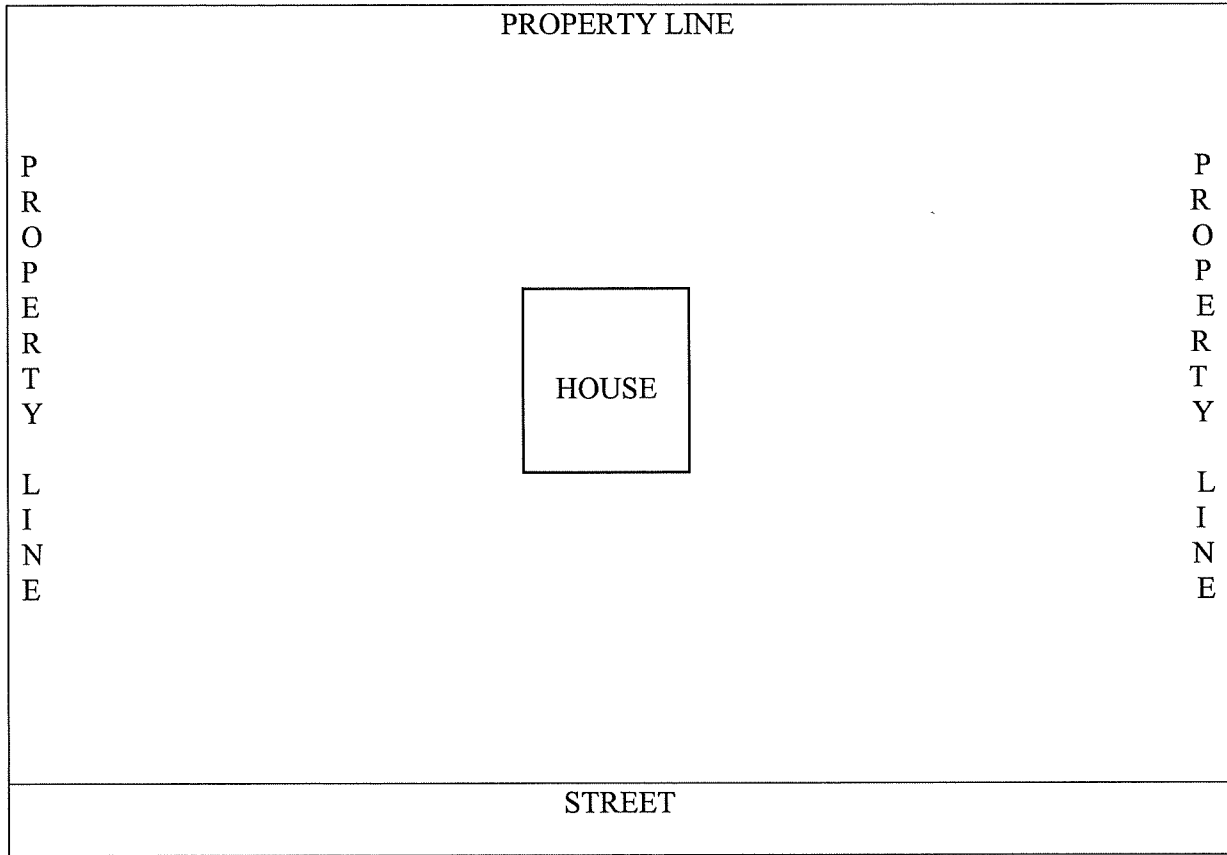

Installer's Certification (This must be completed):

I certify that the information provided above is an accurate description of the work performed.

_____ Date

_____ Installer's Signature

For Office Use Only: Inspection Date: _____ Diagram Received On: _____

Comments : _____

Signature: _____



*Town of Rotterdam
Department of Public Works
1100 Sunrise Boulevard
Schenectady, NY 12306
Phone: 518-355-7575 x395
Fax: 518-355-2725*

TOWN OF ROTTERDAM ON-SITE SEPTIC SYSTEM CONSTRUCTION
CERTIFICATION

The Town of Rotterdam is implementing a certification system to confirm that on-site septic systems are installed as per the approved plans and specifications approved by the Schenectady County Department of Health. All on-site septic systems are to be inspected during construction by a qualified professional. At the completion of construction and prior to issuing a certificate of occupancy, a certified letter by a Licensed Professional Engineer in the State of New York is to be provided to the Building Department stating that the system was installed as per the approved design plans and specifications. The certification letter shall include approved materials used to construct the septic systems that includes the septic tank, distribution box, absorption field piping, stone, any fill material, and pressure distribution system if used due to impermeable soil, high groundwater table, inadequate separation distance from nearby waterbodies, wells, dwellings, property lines and other factors.

The intent for inspection and subsequent certification letter by a licensed professional is to protect property owners to the extent possible, failure of the on-site septic system due to poor workmanship and materials installed that do not meet the design plans and specifications of the new or replacement systems.

Water and Sewer Connections

PERMIT PROCESS

- Permit application for Sewer or Water Connection is to be completed and submitted.
- Town Highway, or County or, State permits to work in right of way if required.
- Site plan showing location and type of all piping and connections to be used.
- All connections shall meet Water and Sewer Districts Requirements.

INSPECTION PROCESS

All connections will be approved by Department of Public Works or designee prior to backfilling.

In addition, any required inspections that are by passed may require re-excavation of the area so that the proper inspection can be performed.

Any questions concerning the above, please feel free to contact Department of Public Works at 355-7575, Ext 395.

The Applicant is responsible for the following:

- Contact Underground Facilities Protection (1-800-962-7962)
 - All excavations and restorations
 - Directional Boring when required

AWWA C651: Standard for Disinfecting Water Mains

Chlorination of Completed Pipelines

- Upon completion of the work, and before final acceptance, the water lines constructed under this contract shall be chlorinated in the presence of the Town Engineer and/or Water/Sewer Maintenance Supervisor. Prior to chlorination, all dirt and foreign matter shall be removed for a thorough flushing through the hydrants, or by other approved means. Each valved section shall be flushed independently.
- The method of disinfection shall consist of introducing a solution of hypochlorite or chlorine gas and water in controlled quantities into the piping system in such proportion that the chlorine-water mixture entering the piping shall contain sufficient chlorine solution so that after the solution has been in the pipeline for a period of twenty-four hours, there shall be a chlorine residual throughout the entire system, of not less than 50 p.p.m. If the residual at any point in the system is less than 50 p.p.m. after the twenty-four hour period, the disinfection procedure shall be repeated until such a residual is obtained at the pipe extremities.

- Following chlorination, all treated water shall be thoroughly flushed from the newly laid pipelines at their extremities until the replacement water throughout its length shall, upon testing both chemically and bacteriologically, be satisfactory to the Town Engineer and/or Water/Sewer Maintenance Supervisor. Should the initial treatment, in the opinion of the Town Engineer and/or Water/Sewer Maintenance Supervisor, prove ineffective, the chlorination procedure shall be repeated until confirmed tests show that the water samples from the newly laid pipe conform to the requirements of the Town Engineer and/or Water/Sewer Maintenance Supervisor.

FEES

Water service permit: \$ 75.00

Water service tap fees:

1. Same side of street tap
\$1,100.00 plus \$4.00/ft.
2. Opposite side of street tap
\$1,500.00 plus \$4.00/ft.
3. Contractor certified installation
(greater than 1") \$1650.00

**Sewer lateral inspection
(building to sewer):** \$ 75.00

Sewer connections:

1. New connection or change of use inside the district or extensions:
 - per dwelling unit \$750.00
 - commercial use \$1,250.00
2. New connection or change of use outside the district or extensions:
 - for three (3) bedrooms or less \$1000.00
 - per bedroom over three (3) bedrooms \$250.00
 - commercial use up to 5,000 sq ft \$1,000.00
 - for each additional 1,000 sq ft \$250.00
3. Apartments/Condominiums:
 - First 1-100 units per dwelling \$750.00
 - 101 units or more per dwelling \$500.00

TOWN OF ROTTERDAM
518-355-7575 EXT 395

PERMIT APPLICATION FOR WATER CONNECTION

| TO BE COMPLETED BY APPLICANT | | DATE: |
|--|---|--------------|
| <p>OWNER INFORMATION</p> <p>Names: _____</p> <p>Address: _____</p> <p>Phone: _____</p> <p>Cell: _____</p> | <p>CONTRACTOR INFORMATION</p> <p>Names: _____</p> <p>Address: _____</p> <p>Phone: _____</p> <p>Contractor Insurance Certificates: Liability Workers Compensation (must accompany application)</p> | |
| <p>Property Location: _____</p> <p>Property Address: _____</p> <p>Proposed Lateral Size & Pipe Type: _____</p> <p>Residential _____ Commercial _____ Multiple Dwelling _____</p> <p>Applicant (Sign) _____ Date: _____</p> | | |
| TO BE COMPLETED BY TOWN OF ROTTERDAM | | |
| <p>Water Rent: _____ Permit Fee: _____</p> <p>Same Side Tap: _____</p> <p>Opposite Side Tap: _____</p> <p>Total: _____</p> | <p>Parcel Identification: _____</p> <p>Road Cut Permit: _____</p> <p>District No: _____</p> <p>Approved: _____</p> | |

ALL WATER CONNECTIONS NEED TO BE INSPECTED / APPROVED BY THE TOWN PRIOR TO BACKFILLING. YOUR COOPERATION IS GREATLY APPRECIATED.

TOWN OF ROTTERDAM
518-355-7575 EXT 395

PERMIT APPLICATION FOR SEWER CONNECTION

TO BE COMPLETED BY APPLICANT

| | |
|--|---|
| <p>OWNER INFORMATION</p> <p>Names: _____</p> <p>Address: _____</p> <p>Phone: _____</p> <p>Cell: _____</p> | <p>CONTRACTOR INFORMATION</p> <p>Names: _____</p> <p>Address: _____</p> <p>Phone: _____</p> <p>Contractor Insurance Certificates: Liability Workers Compensation (must accompany application)</p> |
|--|---|

Property Location: _____

Property Address: _____

Proposed Lateral Size & Pipe Type _____

Residential _____

Commercial _____

Multiple Dwelling _____

Applicant (Sign): _____ Date: _____

TO BE COMPLETED BY TOWN OF ROTTERDAM

| | |
|---|--|
| <p>Fee for Sewer Connection Charge: _____</p> <p>Inspection Fee: _____</p> <p style="text-align: right;">Total: _____</p> | <p>Parcel Identification: _____</p> <p>Road Cut Permit: _____</p> <p>District No: _____</p> <p>Approved: _____</p> |
|---|--|

ALL SEWER CONNECTIONS NEED TO BE INSPECTED / APPROVED BY THE TOWN PRIOR TO BACKFILLING. YOUR COOPERATION IS GREATLY APPRECIATED.

**TOWN OF ROTTERDAM
APPLICATION FOR WATER AND/OR SEWER PERMIT(S)**

| | |
|---|--|
| Property Owner: | |
| Property Address: | |
| Plot: | |
| Lot #: | |
| Lot Size: | |
| Property Owner Phone Number: | |
| | |
| Contractor: | |
| Contractor Address: | |
| Contractor Phone Number: | |
| Liability and Workers Compensation Certificates must be included with application. | |
| | |
| New Construction or Renovation: | |
| If new construction, has built lot been approved? | |
| If existing structure, what is current water service? (Well) | |
| Is this a replacement of an existing water service? If so, what is the reason or problem with existing service? | |
| | |
| Water Service Size: | |
| Copper or Iron Piping: | |
| Water Meter Needed: | |
| Water Tap: (Same Side, Opposite Side Tap or Existing) | |
| | |
| Connect to Public Sewer? | |
| If Yes, Size: | |
| Cast Iron Pipe or Plastic: | |